

PRODUCT DATASHEET						Panasonic	
Product Name :	TV-SAT Socket, Terminated						
Product Code :	WMTC04602**						
Product Series :	Arkedia						
Technical Specifications :							
Material of Button :	ABS (Acrylonitrile Butadine-Styrene)						
Certifications :	CE, WEEE						
Colour Options** :	WH: White, BG: Beige, SL: Silver, BL: Black, DG: Dark Grey, BR: Bronze						
Product Details :							
<ul style="list-style-type: none"> Suitable for central antenna and CATTV. Not affected by the parasite signals coming from the air for shielding feature. Ease of assembly thanks to the rear cover with hinge feature. Can be used in TV Socket 47-2400 MHz band. RG 6 U6 type wire connection is recommended for the image quality. 							
TV-SAT Socket, Terminated							
	TV-SAT						
f/MHz	5-47	47-470	470-862	862-1000	1000-2400	2400	
Subscriber Loss (dB)	≤3,5						
Wiring Diagram and Dimensions:							
Panasonic Electric Works Elektrik.San. ve Tic. A.Ş.							
Abdurrahmangazi Mah. Ebubekir Cad. No: 44 Sancaktepe / İstanbul Tel: 0216 564 55 55 Fax: 0216 564 55 44							
ewtr.panasonic.com							

Panasonic



Product Details :

- Suitable for central antenna and CATTV.
- Not affected by the parasite signals coming from the air for shielding feature.
- Ease of assembly thanks to the rear cover with hinge feature.
- Can be used in TV Socket 47-2400 MHz band.
- RG 6 U6 type wire connection is recommended for the image quality.

TV-SAT Socket, Terminated

	TV-SAT					
f/MHz	5-47	47-470	470-862	862-1000	1000-2400	2400
Subscriber Loss (dB)	<3.5					

Wiring Diagram and Dimensions:

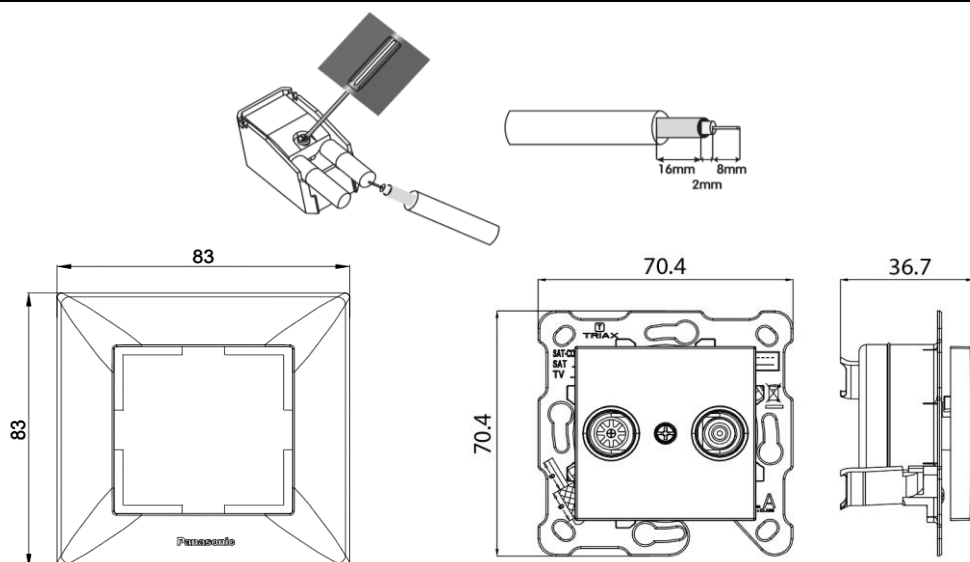

Panasonic Electric Works Elektrik.San. ve Tic. A.Ş.

Abdurrahmangazi Mah. Ebubekir Cad. No: 44 Sancaktepe / İstanbul Tel: 0216 564 55 55 Fax: 0216 564 55 44

ewtr.panasonic.com